

WARNING:
not compatible with LeoVince
LV10 Art. 15201-15201B

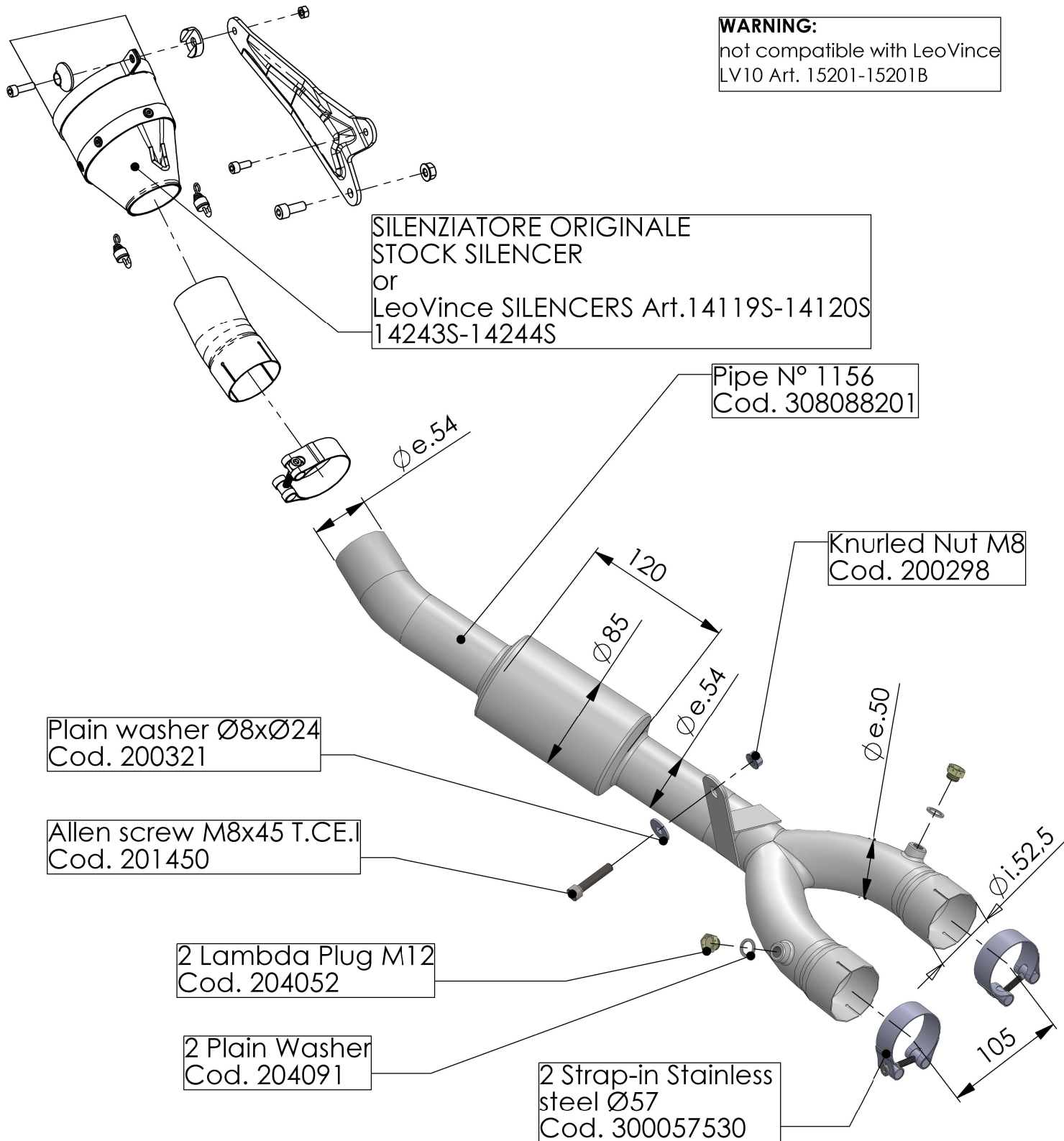

Art. 8088 YAMAHA R1 / R1M

**Collettore INOX / Stainless steel header pipe
per l'eliminazione del catalizzatore originale / kat eliminator link pipe**

- Disconnect the control cables from the exhaust valve on the actuator side;
by removing the original link pipe with the catalytic converter,
also the valve connected to the link pipe and the cables are removed.
The valve's servo motor should not be removed or disconnected.
- Fitting this exhaust system it is advisable to optimize the carburation by remapping
the stock ECU or by adopting an additional ECU unit.
- The link pipe can be fitted both with the stock exhaust and the
LeoVince slip-on 14119S,14120S,14243S,14244S